

*D. Hill*

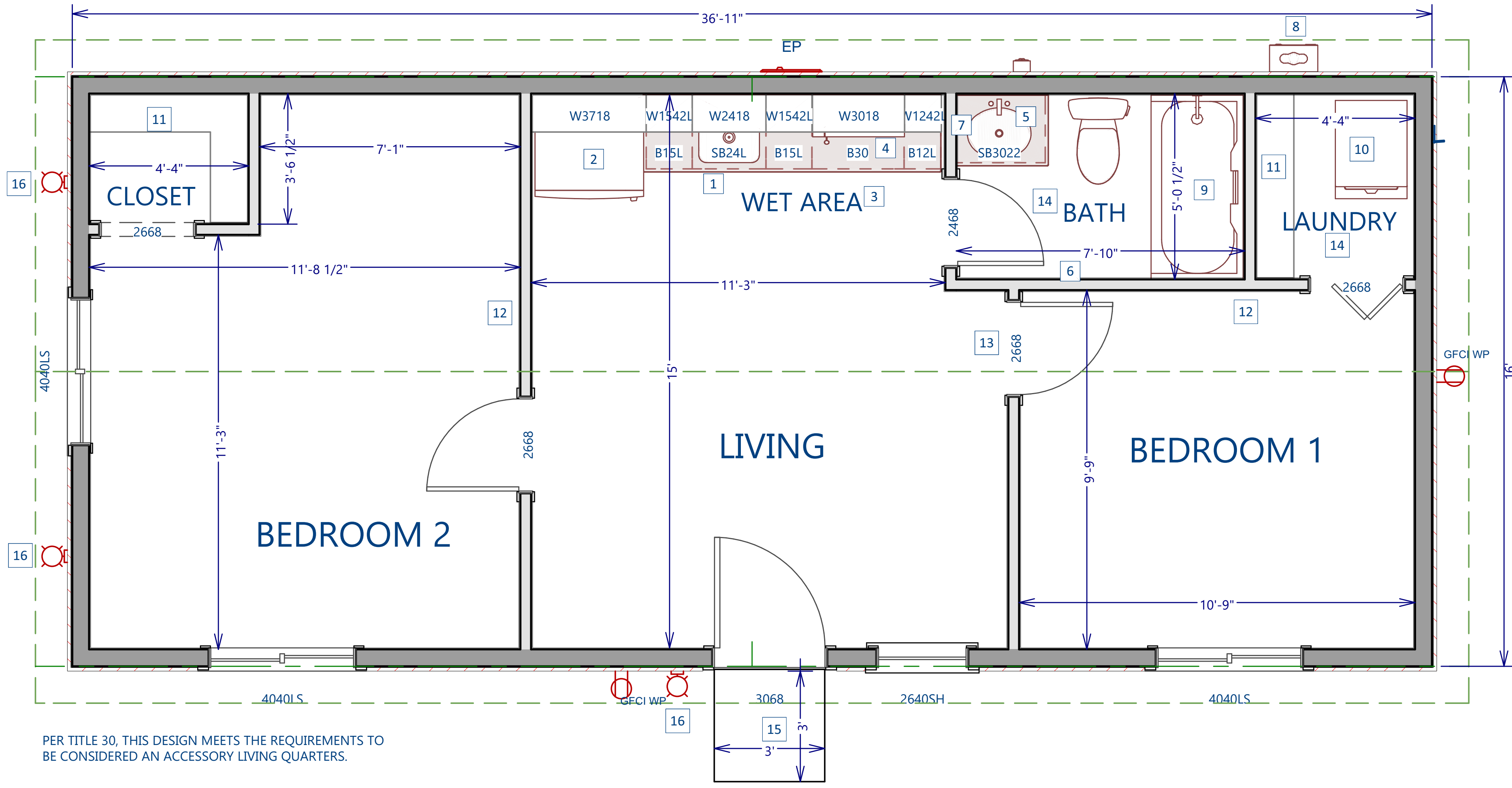

PER TITLE 30, THIS DESIGN MEETS THE REQUIREMENTS TO BE CONSIDERED AN ACCESSORY LIVING QUARTERS.

**LIVING AREA**  
591 SQ FT

**UNIT KEYNOTES**

- 1 SINGLE SINK WITH GARBAGE DISPOSAL
- 2 37 9/16" CLEAR REFRIGERATOR SPACE. PROVIDE RECESSED ICE MAKER LINE
- 3 WET BAR AREA
- 4 MICROWAVE
- 5 30" BATHROOM VANITY
- 6 TOWEL BAR
- 7 RECESSED MEDICINE CABINET
- 8 GAS TANKLESS WATER HEATER
- 9 30" TUB WITH FIBERGLASS SURROUND
- 10 COMPACT WASHER/DRYER SPACE. PROVIDE HOOKUPS
- 11 PROVIDE 12" SHELVING WITH CLOTHES ROD
- 12 INSTALL WALL MOUNTED CASSETTE AIR HANDLER FOR MINI SPLIT
- 13 INSTALL WALL MOUNTED MINI SPLIT AIR HANDLER
- 14 INSTALL EXHAUST FAN IN LAUNDRY AND BATHROOM
- 15 3' X 3' EXTERIOR LANDING WITH 2% SLOPE FOR DRAINAGE.
- 16 COACH LIGHTS

**WALL TYPES**

- A EXTERIOR WALL - 2X6 WOOD STUD SPACED 16" OC WITH 1/2" GYP BD ON INSIDE FACE (STAGGERED) WITH LACE STUCCO FINISH ON EXTERIOR SIDE. INSTALL R-19 BATT INSULATION
- B INTERIOR WALL - 2X4 WOOD STUD SPACED 16" OC WITH 1/2" GYP BD ON INSIDE FACE (STAGGERED). INSTALL R-11 BATT INSULATION.
- C INTERIOR WALL - 2X6 WOOD STUD SPACED 16" OC WITH 1/2" GYP BD ON INSIDE FACE (STAGGERED). INSTALL R-11 BATT INSULATION

**LIGHT AND VENT REQUIREMENTS**

LIVING/WET AREA = 184 SF  
 REQD. LIGHT = 15.0 SF / REQD. VENT = 7.5 SF  
 PRVD. LIGHT = 16 / PRVD. VENT = 8

BEDROOM 1 = 105 SF  
 REQD. LIGHT = 8.5 / REQD. VENT = 4.25  
 PRVD. LIGHT = 32 SF / PRVD. VENT = 12.5

BEDROOM 2 = 132 SF  
 REQD. LIGHT = 10.6 / REQD. VENT = 5.3  
 PRVD. LIGHT = 16 SF / PRVD. VENT = 8

**FLOOR PLAN**  
SCALE 1/2"=1'0"

8325 HICKAM ALQ  
8325 HICKAM AVE  
LAS VEGAS, NV, 89129

Western Trades Construction  
3824 Civic Center Dr #200  
North Las Vegas, NV 89030  
NV LIC 0073190; 79048  
Class B-2

DRAWINGS PROVIDED BY:  
**WESTERN TRADES**  
CONSTRUCTION

DATE:

1/20/2025

SCALE:

1/2" = 1'

SHEET:

A2.0